

We Have Added A Taller EZYTAP75T
With A Dispensing Height Of 24cm
To The Existing EZYTAP75

AA[•]**FIRST**
WATER COOLERS
& BOILERS

EZYTAP75/ EZYTAP75T

Instant boiling water
and ambient water



EZYTAP75 - 18.5cm
Dispensing Height

EZYTAP75T - 24cm
Dispensing Height



EZYTAP7800/ EZYTAP7800T

Instant boiling water
and chilled water



Features

The EZYTAP75T (for tall) has an increased dispensing height of 24cm for easy bottle filling. The dispensing height of the EZYTAP75 is 18.5cm.

The EZYTAP75/75T hot water boiler provides 14ltr/hour of 95°C hot water. By adding an Undersink UC800B to the boiler, the EZYTAP7800/7800T provides 8ltr/hour of between 6 – 10°C chilled water.

Unique boiler scale protection in hard water areas.

The South and Central areas of England are known for high levels of scale – the enemy of boilers! Unlike other tap boilers the EZYTAP has two separate mains water connections. One for the boiler and the other for the ambient supply or the chilling unit. In hard water areas the boiler can be connected to a proper **Scale Removal Filter** and the ambient or chilling to a cheaper carbon filter. This arrangement extends the life of the **Scale Removal Filter** significantly. In a soft water area, both the boiler and chiller can be connected to a joint single carbon filter.

Attention: only proper scale removal filters will protect a boiler from scale and eliminate the need for constant descaling.



AA[•]**FIRST** CE RoHS

refreshingly different

We Have Added A Taller EZYTAP75T With A Dispensing Height Of 24cm To The Existing EZYTAP75

**EZYTAP75/
EZYTAP75T**

**EZYTAP7800/
EZYTAP7800T**

Specifications and performance

Model	Dispensing Height	Hourly output			Dimensions (mm)	Temp
		Hot	Ambient	Chilled		
EZYTAP75	18.5cm	14ltr	indefinite	n/a	329h, 220w, 352d	95C max
EZYTAP75T	24cm	14ltr	indefinite	n/a	329h, 220w, 352d	95C max
EZYTAP7800	18.5cm	14ltr	n/a	8ltr	Boiler 329h, 220w, 352d Chiller 290h, 410w, 210d	95C max 6 – 10C
EZYTAP7800T	24cm	14ltr	n/a	8ltr	Boiler 329h, 220w, 352d Chiller 290h, 410w, 210d	95C max 6 – 10C

Description

Tap

- Chrome faucet with electronic controls
- Touch control dispensing taps
- Flashing indicator light when heating
- Hot water safety tap
- Dispensing height: EZYTAP75/7800 - 18.5cm
EZYTAP75T/7800T - 24cm



Under sink Boiler and Chiller unit

- The EZYTAP75/75T provides hot and ambient water. By connecting a UC800B under sink chiller we create the EZYTAP7800/7800T for hot and chilled water.
- The EZYTAP atmospheric boiler can be opened for inspection & descaling. It includes a powerful 2KW SUS316 ring type heating element.
- The UC800B is a compressor chilled cooler with a static fan assisted condenser
- It is recommended that the boiler and chiller units are installed with 10cm ventilation space around them to avoid over-heating.

Scale protection

- The two separate mains water inlets allow for the installation of a scale removal filter on the boiler inlet and a much more cost-effective taste, odour and turbidity carbon block filter on the ambient/chilled side
- Scale removal filters are expensive and since their effective 'life' is measured in litres of water passing through it, it is important to use it only on the boiler side
- Soft water areas only require a single carbon filter connected to a combined boiler and ambient/chilled inlet
- The EZYTAP boiler can be opened for descaling and servicing.

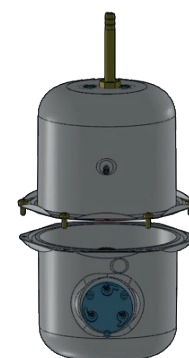

Drip Tray

- EZYTRAY2: Drip tray connects to the EZYTAP column

Venting

- An expansion chamber absorbs the steam/water pressure created during boiling and reduces the risk of drips of water or steam from the tap. It is nevertheless recommended to mount the EZYTAP over a sink or drip tray.

EZYTAP installation diagrams

EZYTAP7800/7800T in soft water area

Single carbon block filter for the boiler and the chiller side.

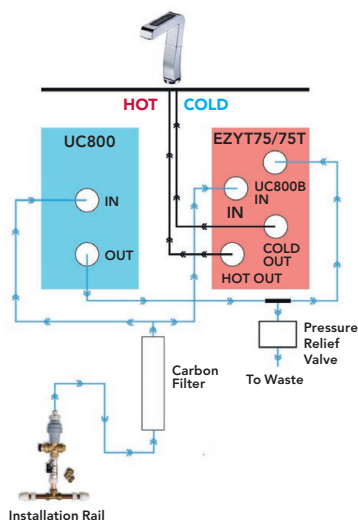

EZYTAP7800/7800T in hard water area

Scale removal filter for the boiler and a carbon block for the chiller side.

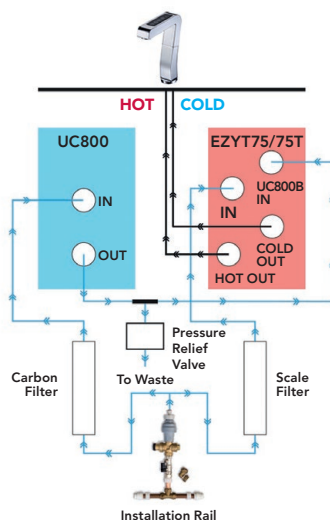

EZYTAP75/75T in hard water area

Scale removal filter for the boiler and a carbon block for the ambient side.

